

EXPLODED VIEW, PARTS LIST AND SPECS

EXPLODED VIEW

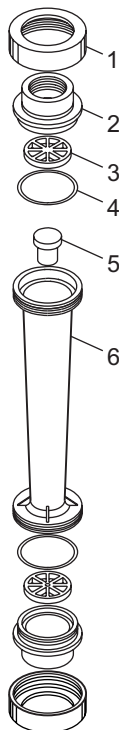

PARTS LIST

Item	Catalog Number	Description	Qty
1	76001-012	Union Nut (PVC)	2
1	90007-158	Union Nut (ALUM)	2
2	76001-037	.50" FPT Adapter (PVC)	2
2	76001-004	.50" FPT Adapter (PVDF)	2
2	76001-042	.75" FPT Adapter (PVC)	2
2	76000-982	.75" FPT Adapter (PVDF)	2
3	91001-146	Float Stop (PSF)	2
4	90003-023	O-ring (Viton)*	1
5	-	Float (PTFE)	1
6	-	Body (PSF)	1

*EP Option Available

ALUM = Aluminum
 PSF = Polysulfone
 PVC = Polyvinyl chloride
 PVDF = Polyvinylidene fluoride

METER SPECS

Scale	Permanent dual scale silkscreen
Max Pressure	See Temperature vs. Pressure chart*
Max Temperature	See Temperature vs. Pressure chart*
Height	10" (25.4 cm)
Width	1.75" (4.45 cm)
Accuracy	± 2.5% of full scale reading

APPLICATION NOTES

Although meters may be suitable for other chemicals, Blue-White cannot guarantee their suitability. It is the responsibility of the user to determine the suitability of the flowmeter in their application. **Flowmeters are tested and calibrated for water only.**

MAINTENANCE

The "Exploded View" drawing illustrates assembly of the F-460 series meter. If your flowmeter needs to be cleaned refer to this drawing when reassembling the unit. The tapered tube may be cleaned with a soft bottle brush. Use a MILD soap and water solution for cleaning purposes. Note the float's "up" position.